



**PRODUCT
COMPONENTS
& HARDWARE
GUIDE**

Floor mount hanging unit:

FLOOR MOUNT VERTICAL PANEL
One finished edge (face forward)



CAM SHELVES
One finished edge (face forward)
Four cams

RECESSED TOE KICK
Unfinished edges
Two eams
2.5" high

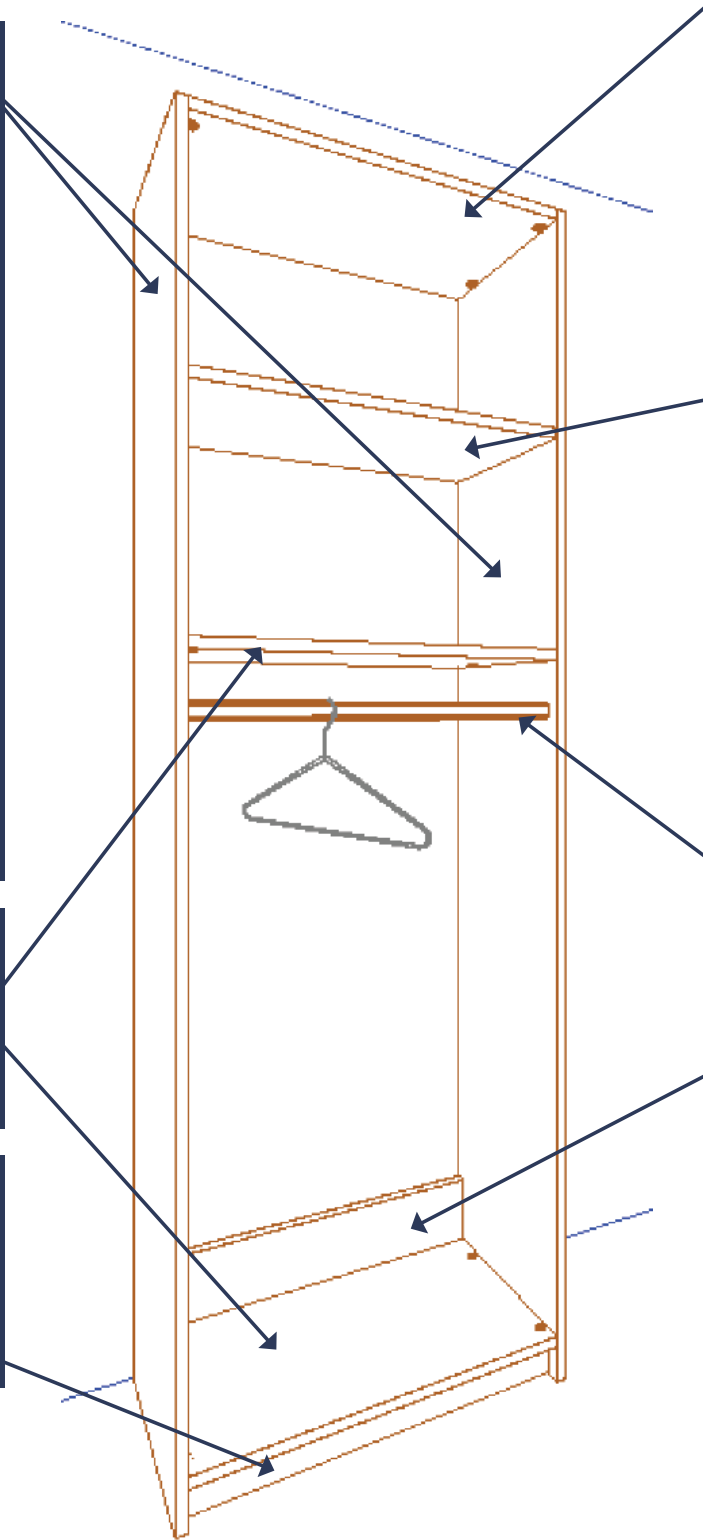

CAM SHELF
One finished edge (face forward)
Four cams



ADJUSTABLE SHELF
One finished edge (face forward)
Four shelf pins



CHROME OVAL HANGING ROD
Two Rod Cups

NAILER
One finished edge (face upward)
This board should fit snugly with no hardware above the bottom shelf
No cams and 5" high
Pro Tip: Use Caulk on the back to stick to wall

Drawer tower unit:

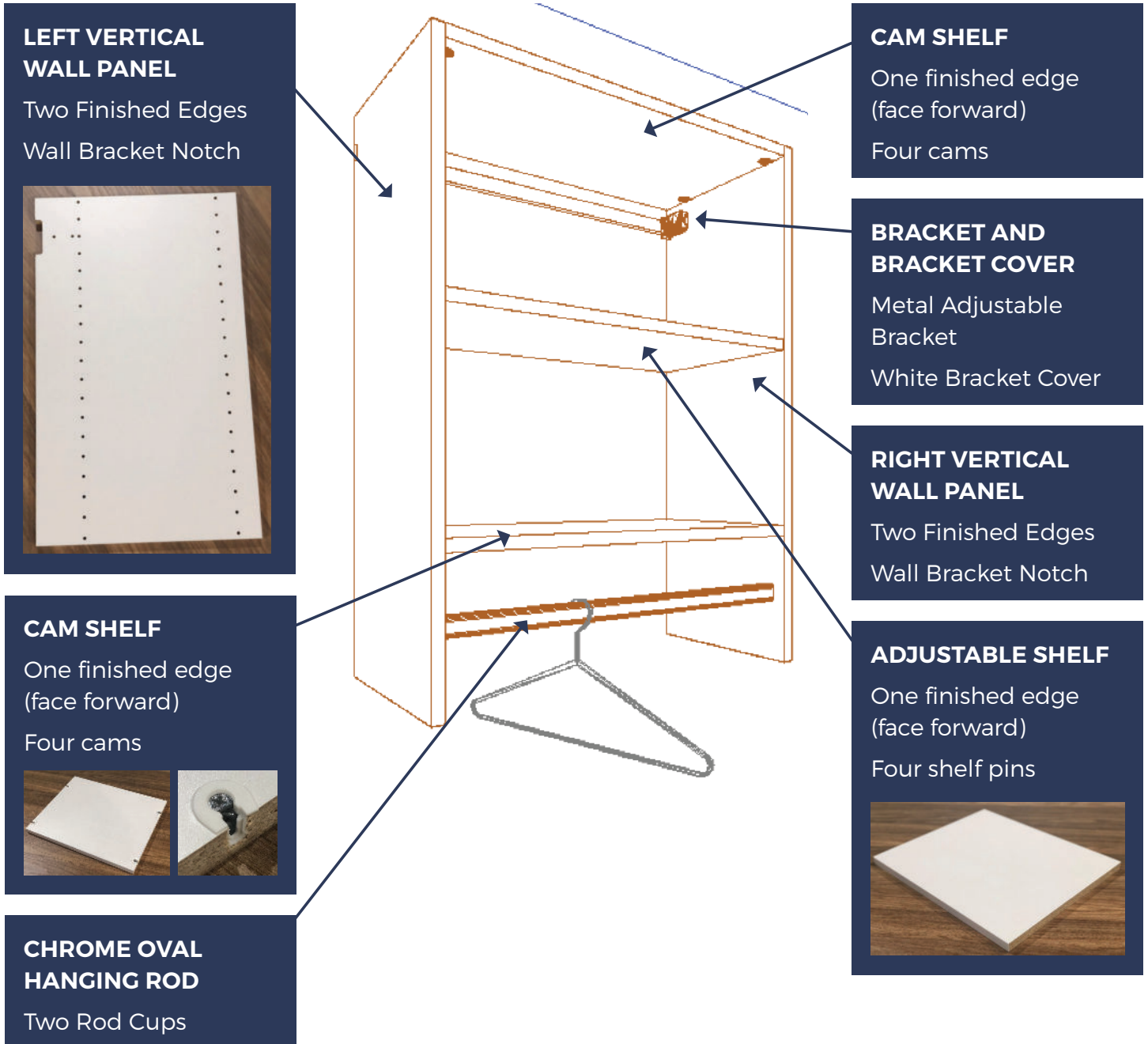

Wall mount hanging unit:

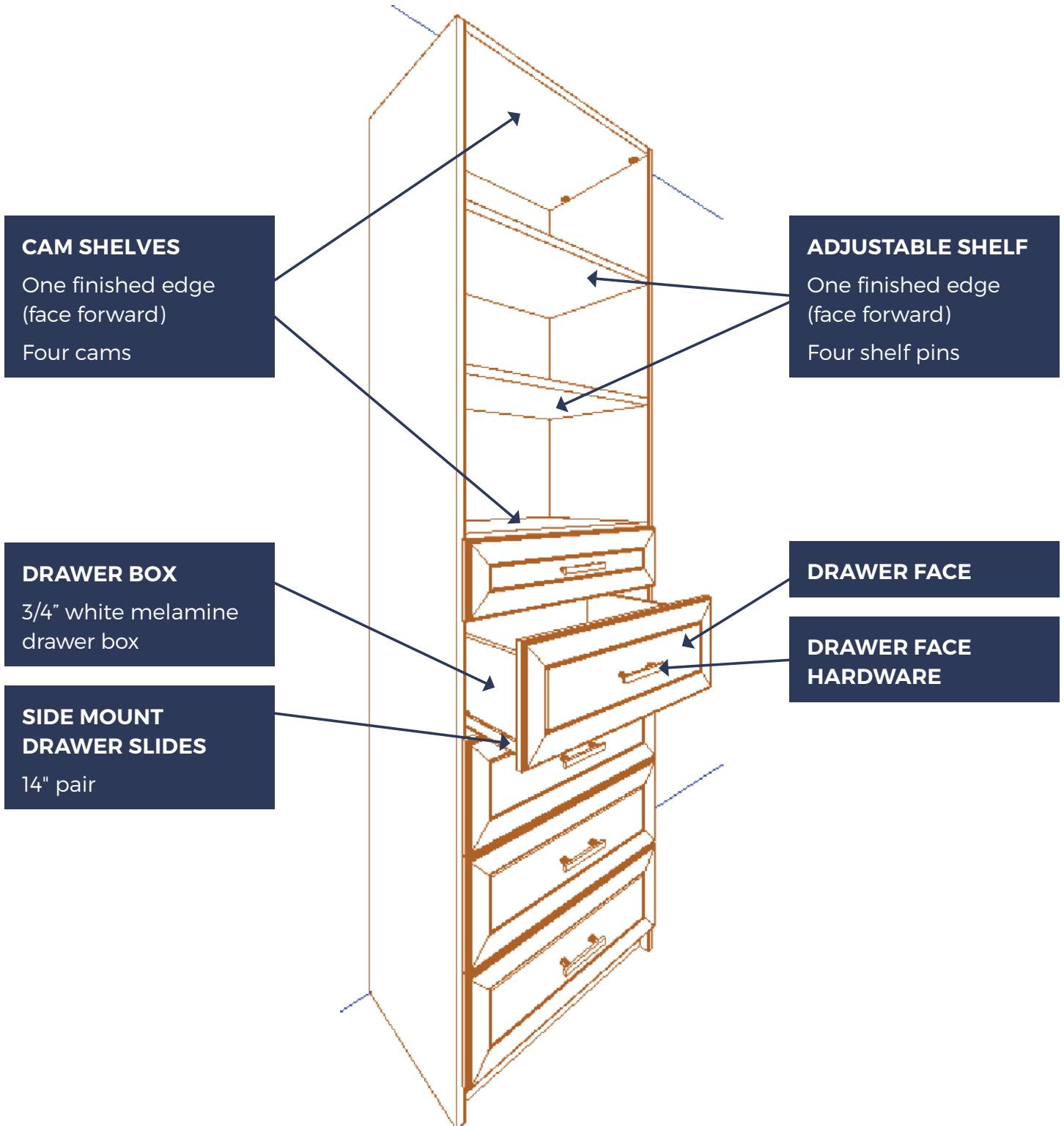

RAIL AND RAIL COVER

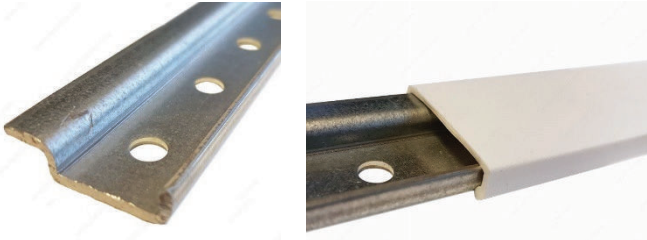

SHELF PIN



**METAL HANGING BRACKET
& BRACKET COVER**



EURO-SCREWS



CHROME OVAL HANGING ROD & ROD CUPS



3/4" SCREWS



ONE-SIDED DOWEL

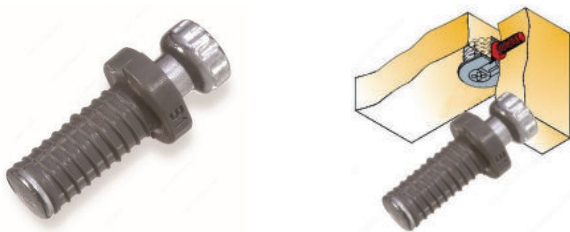

2" SCREWS



TWO-SIDED DOWEL

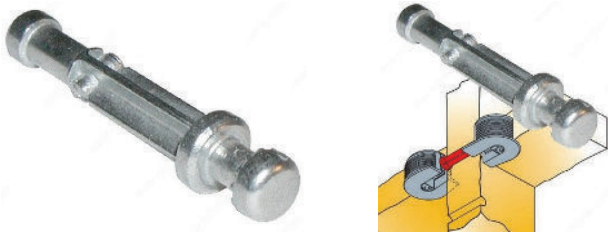

DRAWER FACE SCREWS

IF DESIGN INCLUDES DRAWERS



MENDING PLATE



L-BRACKET



BREAKAWAY SCREWS

IF DESIGN INCLUDES DRAWERS



14" SIDE MOUNT DRAWER SLIDES

IF DESIGN INCLUDES DRAWERS



DRAWER FACE HARDWARE

IF DESIGN INCLUDES DRAWERS

C-PULL HANDLE



BAR PULL HANDLE



HALF MOON HANDLE



KNOBS



OPTIONAL TOUCH UP KITS AVAILABLE

Contact us to order at 1-877-272-7871 or email design@closetparts.com

- Screw hole sticker covers
- Shelf pin plugs
- Touch up putty stick
- White 3 in 1 repair stick

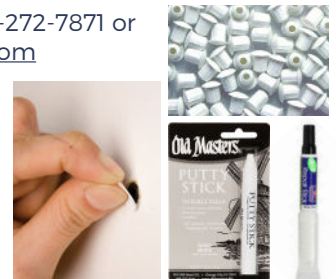

ClosetParts proudly sources our hardware from  Richelieu